

New Product Guide

Protective Roofing Products
Acro Building Supplies
James Hardie
Cougar Paws

ChemLink
Werner
Appleton
3M

IKO
AJC Tools
LINC



Item # 3145575
3M RETRACTABLE LIFELINE
11' Nylon Strap Pro #GW-11

The 3M™ G-Series Retractable Lanyards have a lightweight design. The internal working components are machined for improved resistance to the damaging effects of corrosion. Grivory™ reinforced thermoplastic, is used in the construction of the housing to help make the G-Series Retractable a high strength, lightweight product.



Item #3145576 Pro. #THOR
3M 15' Wire Cable
Retractable Lifeline

The 3M Thor Retractable classic design has stood the test of time and continues to deliver quality. The rugged design of the Thor makes it durable under harsh conditions. Includes swivel top housing and cable spring cushion. The M-15 comes equipped with a 15' galvanized cable and aluminum housing. Meets OSHA and ANSI fall protection standards.



3M Ameba Harness
Pro. #1410
Medium-Large
Item #3141250

3M Ameba Harness
Helical webbing that moves with the wearer
Back and Waist D-Ring, Waist Pad / Tool Belt
Mating Chest and Grommet Leg Connections
Lightweight Airflow Comfort Shoulder Pad with Lanyard clip
Exceeds OSHA 1926, ANSI z359.1 and CSA z259.1



3M Standing Seam
Reusable Roof Anchor
Pro. #4009
Item #3141134



3M Disposable Boot Covers
Pro. #450
Item #3141240
The 450 disposable overboot covers are disposable to provide basic barrier protection to help protect footwear.

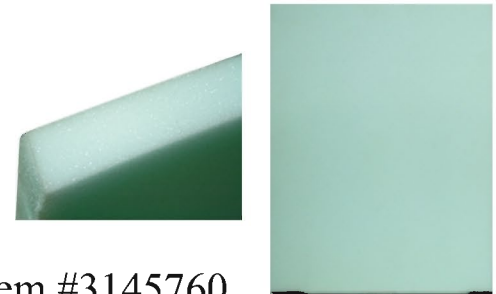

Item #3145760
High Density Foam
Shingle Knee Pad
21.6"x24"

Cougar Paws



COUGAR PAW HI-TOP TENNIS SHOES



- Item #3381070 Size 7
- Item #3381075 Size 7.5
- Item #3381080 Size 8
- Item #3381085 Size 8.5
- Item #3381090 Size 9
- Item #3381095 Size 9.5
- Item #3381100 Size 10
- Item #3381105 Size 10.5
- Item #3381110 Size 11
- Item #3381120 Size 12
- Item #3381130 Size 13

Looks like a sneaker, works like a boot. This boot is ideal for light repairs and estimating work. Offers the new premium lightweight full-grain suede/fabric combination upper for all around support, suspension and durability. Padded collar and tongue for snug and comfortable fit. Features the max-flex stitch-down sole construction. Uses the best lining, with the Aegis anti-fungi and mildew proof velour. Dark Brown fabrics/leather suede upper, with rubber outsole.

COUGAR PAW LEATHER ROOFING BOOTS



- Item # 3380070 Size 7
- Item # 3380075 Size 7.5
- Item # 3380080 Size 8
- Item # 3380085 Size 8.5
- Item # 3380090 Size 9
- Item # 3380095 Size 9.5
- Item # 3380100 Size 10
- Item # 3380105 Size 10.5
- Item # 3380110 Size 11
- Item # 3380120 Size 12
- Item # 3380130 Size 13

Our newest generation Duraflex Boot- Now with a rubberized toe for increased durability. The updated strap slides out for easy replacement. Designed to make even the toughest roofs feel like a walk on the beach, the Duraflex Leather Roof Boot combines the protection and performance you expect with the comfort and support your hard-working feet ache for.

- Improved construction
- Superior flexibility & Extra cushioning
- Speed lacing for added convenience
- Time-tested durability
- Traction pads greatly improves safety on even the steepest roofs

COUGAR PAW REPLACEMENT PADS



- Item # 3382080 Size 7.5-8
- Item # 3382090 Size 8.5-9
- Item # 3382100 Size 9.5-10
- Item # 3382110 Size 10.5-11
- Item # 3382120 Size 12
- Item # 3382130 Size 13

As Cougar Paws' most versatile pad, the Multi-Purpose traction-grip Replacement Pad provides exceptional stability and mobility on roofs of varying surfaces and inclines. It can be attached to any Cougar Paws boot and may also be used for street wear without compromising it's roofing performance.

Ideal for plywood, wood shakes, felt, slate, shingles and more
Velcro attachment adheres to all Cougar Paws boots

COUGAR PAW DURAFLEX REPLACEMENT STRAPS



- Item # 3380030 Size XSM (3-5)
- Item # 3380031 Size SM (6-8)
- Item # 3380032 Size M (8.5-11)
- Item # 3380033 Size L (12-14)

COUGAR PAW HI-TOP SHOE REPLACEMENT STRAP



- Item # 3380040 Size XSM (3-5)
- Item # 3380041 Size SM (6-8)
- Item # 3380042 Size M (8.5-11)
- Item # 3380043 Size L (12-14)

COUGAR PAW DURAFLEX BOOT LACES



- Item # 3380010 Size SM (3-6)
- Item # 3380011 Size M (7-9.5)
- Item # 3380012 Size L (10-14)

COUGAR PAW HI-TOP TENNIS SHOE LACES



- Item # 3380020 Size SM (3-6)
- Item # 3380021 Size M (7-9.5)
- Item # 3380022 Size L (10-14)

Acro Building Supplies Werner

REESE
WHOLESALE.COM



Acro X-warning System #21000 Item #3145537

- Quick set up and take down
- Reusable and easy to store
- Complies with OSHA regulations
- Creates safety perimeters on commercial roofs
- Works for ground applications as well
- 42" Posts for high visibility
- Set of four includes 130' of warning flags
- Powder coated safety yellow
- Made in America



Acro X-warning Flag Line 130 ft #21000 Item #3145538
Replacement warning flag line for the X-warning System- 130 Ft
Acro X-warning Flag Line 100 ft #21030 Item #3145539
Replacement warning flag line for the X-warning System- 100 Ft



Item #3145529 ACRO PARAPET WALL GUARDRAIL SYSTEM

- Assembles quickly from inside of parapet
- Guardrail post is always on inner side of parapet wall to meet OSHA height regulations throughout its use
- Coarse adjustment 4" to 24" - thumb screw tightened
- Easily installed by one person without ladders or scaffolds
- Parapet bracket weighs only 19lbs. full assembled
- The guard post is included with the #12090 system.
- Individual units can be moved without complete disassembly of units and guardrail posts
- Maximum spacing 8' apart (used with construction grade lumber)
- Can be used for fall protection
- Complies with OSHA regulations
- Powder coated safety yellow



WERNER JOB CADDY Item # 3145746 Part#: AC54-JC

AC54-JC JobCaddy

Add a second set of hands with our new job caddy. Ideal for holding large or odd shaped items.



WERNER JOB BUCKET 3 PACK Item # 3145745 Part#: AC50-JB-3

AC50-JB JobBucket

Increase ladder storage and maximize your work space. Integrated tape measure and screwdriver holders. Top grooves hold round pipes in place. 600 cubic inches of storage, 25 lbs. capacity.

Werner



REESE
WHOLESALE.COM



FIBERGLASS EXTENSION LADDER

375 Lb Load Capacity

Item # 3145750 Part #D7128-2 28'

- Pre-pierced holes for easy field installation of accessories
- Interlocking side rails
- Base and fly separate easily to use base section as single ladder
- Nylon coated internal guides on bottom of fly section increase ease of operation
- Shoe with slip-resistant pad and spur plate
- Durable rail shield and shoe bracket protects rail from damage
- Rope clamp ties rope to rung
- Rugged gravity spring locks operate smoothly
- Slip-resistant Traction-Tred® D-rungs
- Plate and rung assembly are riveted at four points to each side rail to allow for rung replacement
- Heavy duty pulley with rope
- External guides at top of base section securely interlock rails
- Mar-resistant molded end caps
- Exclusive Alflo® rung joint means Twist-Proof® performance



WERNER FIBERGLASS

EXTENSION LADDER 300LB Load Capacity

Item # 3145701

Part#: D6240-2 40'

Pre-pierced holes for easy field installation of accessories

Item # 3145703

Part#: D6236-2 36'

Direct rung to rail connections

Interlocking side rails

Item # 3145705

Part#: D6236-2 32'

Base and fly separate easily to use base section as single ladder

Internal guides on bottom of fly section securely interlock rails

Item # 3145707

Part#: D6228-2 28'

Molded rung braces

Durable rail shield bracket and shoe with Shu-Lok®, slip-resistant pad and spur plate

Rope clamp ties rope to rung

Item # 3145709

Part#: D6224-2 24'

Rugged gravity spring locks operate smoothly

Slip-resistant Traction-Tred® D-rungs

Item # 3145711

Part#: D6220-2 20'

Heavy duty pulley with rope

External guides at top of base section securely interlock rails. Two sets on 36' and 40' models

Mar-resistant molded end caps

Exclusive Alflo® rung joint means Twist-Proof® performance



WERNER ALUMINUM

EXTENSION LADDER 300 LB Load Capacity

Item # 3145700

Part#: D1540-2 40'

Exclusive Alflo® rung joint means Twist-Proof® performance

Mar-resistant end caps

Item # 3145702

Part#: D1536-2 36'

Thick guide bracket engages full fly rail

Smooth operating pulley design - enclosed shape protects pulley

Item # 3145704

Part#: D1532-2 32'

Extra heavy duty I-beam rails

Base and fly separate easily for use as an extension or two single sections

Item # 3145706

Part#: D1528-2 28'

Slip-resistant Traction-Tred® D-rungs

Rugged spring loaded locks operate smoothly

Item # 3145708

Part#: D1524-2 24'

Guide brackets for durability and smooth operation of fly section

Rugged shoe rests flat or is held in spur position with Shu-Lok® feature

Item # 3145710

Part#: D1520-2 20'

Protective Roofing Products



Item # 3145523 PR2000 WORK PLATFORM

When using the PR 2000 on your roofing project, you will find that it will speed up production by controlling falling debris on those steep roof tear offs, minimizing ground clean up and ground damage. The system will give you a strong stable working platform from the beginning to the end of the project without interfering with a roofing work, soffit fascia, gutters or cornice work. A safe working environment is created and loading material onto steep roofs is made easier with the use of the PR 2000. The system allows for the installation of gutters with a roof flange.



Item # 3145522 PR20 EAVE CATCHGUARD

The PR 20 Eave Catchguard is an easily installed guardrail for steep roofs that controls debris on those steep roof tear offs. The fastening bracket is slotted like a common roof jack, allowing the new roofing material to be installed right over the bracket.

The PR 20 Catchguard System was tested to withstand fall impacts which exceed OSHA and WCB standards, making it safe for workers on the roof and on the ground.

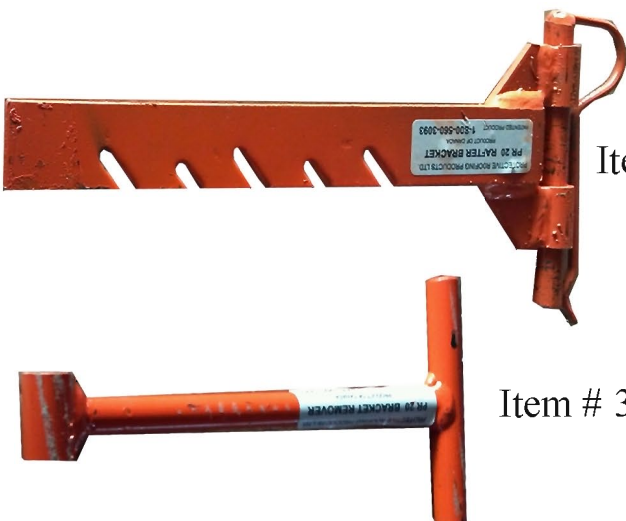
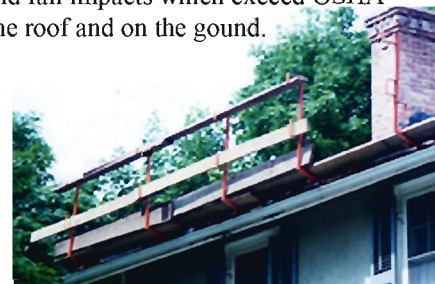
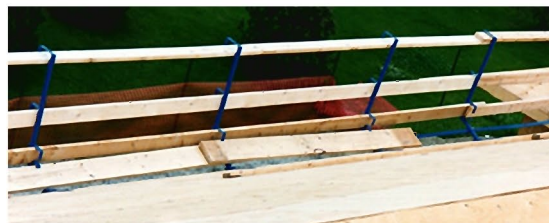
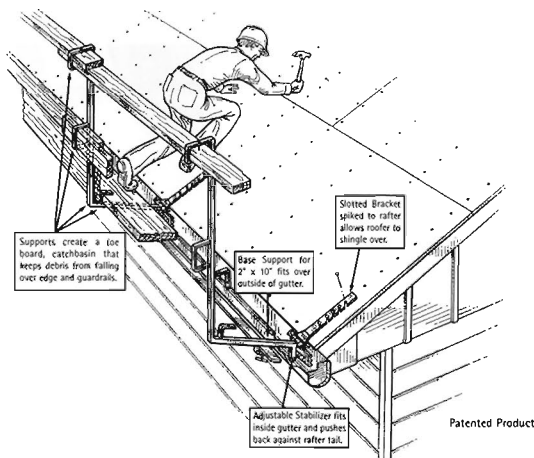

Item # 3145524 RAFTER BRACKET

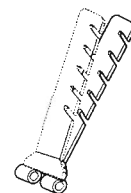

Item # 3145525 RAFTER BRACKET REMOVAL TOOL

Acro Building Supplies
Werner
IKO
AJC Tools

LINC
GAF
James Hardie
ChemLink
Appleton

REESE
 WHOLESALERS.COM



Item #1511030
IKO HIP & RIDGE 12
REGAL STONE
 A distinctive color blend is used to create a deep, shadowed, dimensional appearance that will dramatically highlight the roofline and give your home a more impressive appearance.



Item #3124156
RIP HAMMER
WITH WOOD HANDLE



Item #3124114 **AJC MAG-HATCH**
MAGNETIC ROOFING HATCHET
 For fast application of felt cap and roofing nails. Powerful, shielded neodymium magnet located in striking face. Sliding Gauge. Built-in utility blade and handy nail claw. Patent Pending. Weight: 17oz.

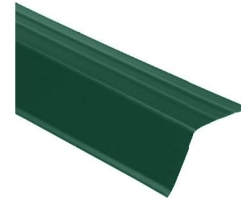

Item #3600113
APPLETON
2X3 GUTTER APRON
HUNTER GREEN



Item #3600013
APPLETON
1.5IN DRIP EDGE
HUNTER GREEN

James Hardie NT3 Trim

Item #5401600 4/4X4" **ARCTIC WHITE**
Item #5401601 4/4X6" **ARCTIC WHITE**

There are many advantages of using a 12' HardieTrim board.

- Improved aesthetics with concealed fastening system
- Fewer seams and reduced waste
- Quicker installation
- Improved handle-ability

Item #3500045
GAF DRILL-TEC
#15 XHD 7" SCREW



Item #3500008
GAF DRILL-TEC
#12 STANDARD 7" SCREW



Item #2501088 F1234GR **NOVALINK**
SL SEALANT GRAY 10.1 OZ
Item #2501089 F1234ST **NOVALINK**
SL SEALANT ST ONE 10.1 OZ

- Bonds to concrete and aged asphalt
- Solvent free, 100% solids, will not shrink
- 30 minute skin over, resists dirt pick up
- No outgassing on damp surfaces
- Abrasion resistance

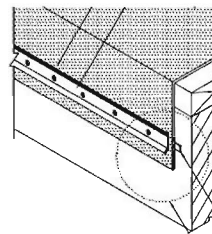

Item #2309200
GAF LIP TERM BAR
6" O.C.

Extruded aluminum termination bar with angled lip caulk receiver and lower leg bulb stiffener. Pre-punched lotted holes at 6" on center 3/4" x 10' with 0.090" cross section,

Item #3237005 LINC BeA 380/10 **STAPLE JK 680**
Item #3237035 LINC BeA 71/10 **C 06 670 WIRE S**

18,000 Staples/Box
20,000 Staples/Box

