

# New Product Guide



James Hardie  
Firestone  
AJC  
3M

Shingle Elevator  
Roofmaster  
Clarke Safety  
Qual-Craft

Broan  
Napco  
Soprema



Item #3030060  
Broan DT4W  
Insulated Flexible Duct

- For 4" round.
- 25' standard length.

Item #3030070  
Broan DT6W  
Insulated Flexible Duct

- For 6" round.
- 25' standard length.

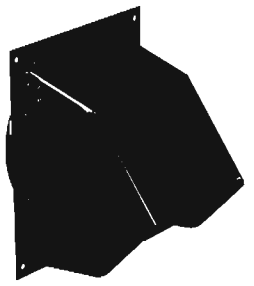

Item #3030030  
Broan Black Wall Cap  
Model 843BL

- For 6" round duct
- Spring-loaded backdraft damper and bird screen
- Black electrically-bonded epoxy finish
- Not intended for Dryer Vent usage



Item#5401785  
NT3 Trim Timber  
Hardie 5/4 x12'

New HardieTrim® 12' boards have been specifically designed to deliver superior performance under varying climatic conditions. Made of the highest quality materials available, dimensionally stable HardieTrim boards are resistant to damage from water, insects, harsh weather and are low maintenance for long lasting beauty.



EcoWhite EPDM 6"  
QuickSeam Flashing  
Item #2053020

Firestone EcoWhite EPDM 6" QuickSeam Flashing is a semi-cured EPDM flashing laminated to cured QuickSeam tape. EcoWhite EPDM QuickSeam Flashing is used to flash gravel stops and other details.



EcoWhite EPDM 12"  
QuickSeam Flashing  
Item #2053022

Firestone EcoWhite EPDM 12" QuickSeam Flashing consists of semi-cured Flashing factory laminated to cured QuickSeam Tape. It is designed to flash inside and outside corners, pipes, penetration pockets and other applications.



Item #5131011 58 1/8" X 21 1/8"  
NAPCO CEDAR SELECT  
HAND SPLIT CACTUS

The rustic look of wood is the hallmark of Cedar Select® Shingle Siding. This durable siding offers the great texture and character of shingle siding without the hassle of scraping and staining.

Shingle Elevator  
Roofmaster  
Napco  
AJC



**Item #3330100 1 Story Shingle Elevator**

Shingle Elevator is a shingle lift, shingle hoist, shingle conveyor, shingle ladder that can place 10 square on the roof every 5 minutes and weighs 85 pounds WITH the motor! Our 22" wide x 15' 8" long Single Story Shingle Elevator is built with lightweight, aircraft grade aluminum.



**Item #3330200 2 Story Shingle Elevator**

2 Story Shingle Elevator is 22" wide x 24' 8" long and can place 10 square on the roof every 8 1/2 minutes! Built with aircraft grade aluminum, it weighs only 115 pounds WITH the motor.

- Item # 5302100 ROOFMASTER PAINT WEATHEREDWOOD**
- Item # 5302101 ROOFMASTER PAINT CHARCOAL - BLACK**
- Item # 5302102 ROOFMASTER PAINT HICKORY - BROWN**



Finish the job professionally...and close every sale with Roofmaster Roof Flashing Paint! Premium Grade Quality = less sun fading Heavy Duty & Good Hide = fewer coats to apply High Solids Content = 1-2 coats only Easy & Thick Application = will not run or drip Good \$ Value = better coverage per can Bilingual Label = English & Spanish

**Item #5011153  
Napco PVC  
Flagstone Coil**

Matches CertainTeed Flagstone

- Description
- 24" coil width
  - nominal thickness .019"
  - PVC coated striated finish
  - 50' length



**Item #3104170 AJC 75LB  
HEAVY STEEL ROLLER**

Heavy-duty, contractor quality. 3 individual rollers adjust to irregular surfaces. Removable legs allow unit to remain standing when not in use and aid in transport.



## 3M Qual-Craft Clarke Safety

# REESE

WHOLESALE.COM

### ORANGE MESH TUX HARNESS MEDIUM

Item #3145670

### ORANGE MESH TUX HARNESS LARGE

Item #3145680

#### FEATURES:

- Harness is built into the vest to create a no tangle body wear system
- Leg straps zip into the back of the harness for storage
- Dorsal & Side positioning D-rings are standard
- Impact indicator
- Durable zipper
- Notched pass-through chest and leg buckles fasten without twisting
- Comfortable and breathable mesh, or durable cotton duck material
- Washable materials
- Sized for proper fit and adjustment
- All construction Tux models are made with reflective strips down the front for visibility



### SERAPH HARNESS M/L

Item #3145650

### SERAPH HARNESS XL/XXL

Item #3145660

#### FEATURES:

- Shoulder pads
- Five points of adjustment
- Stretch ability in the shoulders and back
- Cradle seat
- Quick adjust torso buckles
- Two lanyard keepers
- Impact indicator and inspection log tag
- Optional tongue buckle leg straps
- Optional side D-rings



### 3M Vflex Dust Mask

Item #3141223

NIOSH N95



### Skyhook Swivel Top

Item #3145610

#### FEATURES:

- Mounts on top of the Skyhook
- Easy installation
- Swivels 360 degrees
- Removable and reusable bolt-on application
- Cost effective accessory to the Skyhook
- Great for first-worker-up system



### SkyMast SKYHOOK 4/12 - 6/12

Item #3145630

### SkyMast SKYHOOK 7/12 - 9/12

Item #3145640

#### SkyMast Skyhook

This specially designed Skyhook allows for attachment down the center of a truss with screws. This is the stabilizer to the SkyMast.

#### SkyMast

Item #3145620

#### FEATURES:

- Mounts on top of a roof
- Includes 3 retractable cradles which rotate 360 degrees
- Accommodates most retractables up to 65'
- Schedule 80 pipe provides a super strong center post
- The base plates provide further absorption to the system as they engage three trusses
- Does not include retractables
- Fasteners included

### SKYHOOK 4/12 - 6/12

Item #3145590

### SKYHOOK 7/12 - 9/12

Item #3145600

- Patented permanent anchor point for: wood: 3/4" CDX ply-wood or better metal: 20 gauge or thicker
- Powder-coated for a durable weatherproof finish





**Warning Line Systems**

**Item #3145510**

**TRANSPORTER**

Lets you roll up to 465 lbs with ease  
Holds up to 9 stanchions  
Built-in reel holds 300 ft of flagged line  
Built-in ring for hoisting to a roof  
**STANCHION**

Easy-to-store stanchion for reusable warning line  
Use one stanchion every 50 ft  
Weighs only 39 lbs; are 39 1/2" high  
**100' REPLACEMENT FLAG LINE**  
Large, yellow heat-sealed flags spaced every 12"  
Heavy-duty nylon cord  
OSHA compliant



**100' REPLACEMENT FLAG LINE**

**Item #3145520**

Large, yellow heat-sealed flags spaced every 12"  
Heavy-duty nylon cord  
OSHA compliant

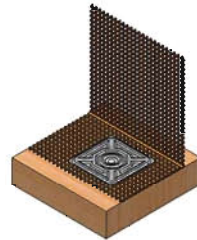

**48" Orange Fire Retardant Debris Net PE 150' Roll Item #3145500**

Nets are comprised of a double strand configuration making them strong and durable. The debris netting contains F and UV coatings to provide a longer lasting product. Our netting products are designed to withstand wind, rain, sun and other environmental conditions that can be damaging.



**Residential Guardrail System**

**Item #3145530**

Guardrail system which allows roofing activities to be performed safely. The Ultra-Adjust Roof Bracket is designed for five different positions from 6/12 to 16/12. When used in conjunction with 2" X 4" and 2" X 6" toe boards, this continuous guardrail system complies with OSHA's regulations.

**FEATURES:**

- Roof bracket includes guardrail holder and bracing support
- Lightweight system
- Adjustable from 6/12 to 16/12
- Slotted for easy removal
- Compact for storage
- Can be used as a slide guard
- Can be used for fall protection on roofs less than 6/12 with a ground to eave height less than 25 ft.
- Maximum spacing 8' apart



**Stair Mount For Guardrail Post**

**Item #3145550**

Made of durable welded steel  
Designed to fit metal guardrail posts  
Mounts with 4 screws or nails  
Engineered for use on concrete 2,000 psi+  
Mount is 10" (L) x 6" (W) x 6" (H)

**Stair Boot for 2x4**

**Item #3145540**

Made of durable welded steel  
Designed to fit 2x4 wood posts  
Mounts with 4 screws or nails  
Engineered for use on concrete 2,000 psi+  
Mount is 6" (W) x 10" (L), 6" (H)



**Guardrail Posts**

**Item #3145560**

Made of lightweight welded steel  
Installs easily into mounts  
Available in 52" / 65" / 74" sizes  
Maximum spacing 8' apart

ALSAN FLASHING is a patented polyurethane/bitumen resin, single-component, moisture cured compound that utilizes low solvent technologies. Used in combination with ALSAN PolyFleece, they create a watertight, puncture and UV resistant liquid applied flashing or field membrane that is preferred by roofing contractors, architects and building owners.

- Item #2220120 5 GAL ALSAN FLASHING
- Item #2220122 1 GAL ALSAN FLASHING
- Item #2220180 4" X 50' ALSAN FLASHING SCRIM
- Item #2220182 6" X 50' ALSAN FLASHING SCRIM



**SOPREMA's heat applied SBS Modified Bitumen membranes**

Through a mixture of chemically engineered components, SOPREMA membranes redefine the qualities indispensable to a high-performance roof membranes: elasticity, cyclic fatigue resistance and high resistance to heat aging. The membranes are composed of selected bitumens and SBS synthetic rubber polymers.

- Item #2220410 1 SQ SOPRALENE FLAM 180 BASE SHEET
- Item #2220201 1.5 SQ ELASTOPHENE SANDED BASE SHEET
- Item #2220300 1 SQ ELASTOPHENE FR GR WHITE
- Item #2220336 1.5 SQ ELASTOPHENE 180 PS
- Item #2220510 1 SQ ELASTOPHENE FLAM GR WHITE CAP SHEET



SOPREMA has been manufacturing roofing and waterproofing products since 1908. Over the last 100 years, we have perfected the art of creating the world's finest SBS Modified Bitumen roofing membranes.

- Item #2220345 1 SQ SOPRALAST 50 TV ALU
- Item #2220350 3 SQ MODIFIED SOPRA G BASE SHEET
- Item #2220600 1/8" 4x8 SOPRABOARD

<b>FIELD MEMBRANES SELECTOR</b>	Method of Application	BASIC	OPTIMAL	HEAVY DUTY
FIELD BASE MEMBRANE PLY	MOP	23 ELASTOPHENE PS	24 ELASTOPHENE 180 PS	34 SOPRALENE 180 PS 3.5 MM
FIELD CAP MEMBRANE PLY	TORCH	53 ELASTOPHENE FLAM GRANULES	50 SOPRALENE FLAM 180 GRANULES	51 SOPRALENE FLAM 250 GRANULES
	• FIRE RATED - TORCH	55 ELASTOPHENE FLAM FR GRANULES	48 SOPRALENE FLAM 180 FR GRANULES	54 SOPRALENE FLAM 250 FR GRANULES



<b>FLASHING SYSTEMS</b> Method of Application	<b>FLASHING SYSTEMS DESIGNATION</b>	STANDARD		HEAVY DUTY	
		FIRST MEMBRANE FLASHING PLY	CAP MEMBRANE FLASHING PLY	FIRST MEMBRANE FLASHING PLY	CAP MEMBRANE FLASHING PLY
	<b>A</b>	32 SOPRALENE FLAM 180	50 SOPRALENE FLAM 180 GRANULES	31 SOPRALENE FLAM 250	60 SOPRALENE FLAM 350 GRANULES
			57/58/SOPRALAST 50 TV ALU/COPPER/STAINLESS	36 SOPRALENE FLAM 350	60 SOPRALENE FLAM 350 GRANULES
	<b>B</b>	24 ELASTOPHENE 180 PS	50 SOPRALENE FLAM 180 GRANULES	34 SOPRALENE 180 SP 3.5 MM	51 SOPRALENE FLAM 250 GRANULES
			57/58/SOPRALAST 50 TV ALU/COPPER/STAINLESS		60 SOPRALENE FLAM 350 GRANULES